

ComSat®



Air Pumps

康盛牌旋涡气泵

Feature 特点:

Low noise with built-in and high-efficiency silencers
 内装高效消音器，低噪声
 Dust-tight oil seal and bearings 使用带防尘设计的轴承及机体
 Compacter size, lighter in weight unit and higher air-pressure
 without lubricating oil 结构紧凑轻巧，高压无油设计

Technical Data 技术参数

Three phase 380V, other voltage available upon request.
 基本型为三相380V，可以按要求提供适用于其它电压的产品。

Model 型号	Power Hp马力	Power 功率 W	Frequency 频率 Hz	Current 电流 A	Max P 最大风压 mmAq	Max Q 最大风量 m3/min	Max V 最大吸力 kpa	Noise Level 噪声 dB	In/Out let 吸吹口径	装箱尺寸 mm LxWXH	重量 Kg
HB370	0.5	370	50/60	0.8	700	1	5	65	1.25 " X1.25 "	270X270X280	10
HB550	0.75	550	50/60	1.1	1200	1.4	9	65	1.25 " X1.25 "	300X290X290	12
HB750	1	750	50/60	1.4	1600	1.9	12	67	1.5 " X1.5 "	270X310X350	16
HB1100	1.5	1100	50/60	2.2	1800	2.3	14	67	1.5 " X1.5 "	350X340X390	20
HB1500	2	1500	50/60	3.1	2100	3.7	17	70	2 " X2 "	350X360X420	28
HB2200	3	2200	50/60	4.1	2400	5.1	18	70	2 " X2 "	380X390X440	34
HB3700	5	3700	50/60	7.3	2600	6.5	21	77	2 " X2 "	450X460X490	52
HB5500	7.5	5500	50/60	9.1	2700	8.4	22	77	2.5 " X2.5 "	470X470X530	72
HB7500	10	7500	50/60	11	2800	11	23	80	2.5 " X2.5 "	550X500X550	82
RB2	0.2	150	50/60	0.8	450	0.63	3	65	1 " X1 "	220X220X200	11
RB10	1	750	50/60	1.4	1300	1.8	9	67	1.5 " X1.5 "	310X320X340	18
RB15	1.5	1100	50/60	2.2	1400	2.5	10	67	1.5 " X1.5 "	320X320X340	21
RB20	2	1500	50/60	3.1	1800	3.9	14	70	2 " X2 "	410X400X370	32
RB30	3	2200	50/60	4.1	2100	5.3	17	70	2 " X2 "	425X410X410	39
RB50	5	3700	50/60	7.3	2800	6.3	22	77	2 " X2 "	485X440X450	58
RB50A	5	3700	50/60	7.3	2400	7.1	18	77	2.5 " X2.5 "	485X440X450	59
RB75	7.5	5500	50/60	9.1	2600	8.8	19	80	2.5 " X2.5 "	600X570X600	87
RB100	10	7500	50/60	11	2700	11.2	21	80	3 " X3 "	600X570X620	98
RB150	15	11kW	50/60	18	3600	18	25	83	4 " X4 "	680X680X730	132
RB200	20	15kW	50/60	23	4800	24.5	28	83	4 " X4 "	680X680X730	152

可提供单相风机，功率可做到2.2kW，尺寸及风力性能与上表相同，仅电流增加约1.8倍
 Used in Single Phase can be provided up to 2.2kW with the same performance listing above, but different current.

Application: Air Supply 应用举例：送风用

Incinerator 焚烧炉

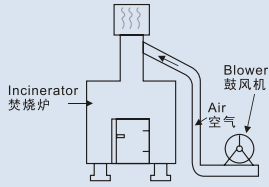

Help to improve the incinerator burning completely and speeding up its air discharge. Protect our environment.

可提高焚烧效果，促进排出气体。

Fuel furnace 煤气炉

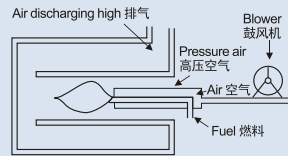

Capable of discharging the air with high pressure and transforming the fuel into tiny molecules to help burning.

可借助高压排出空气，使燃料变成微粒分子，以帮助燃烧。

Small particles transferring 粉力体之输送

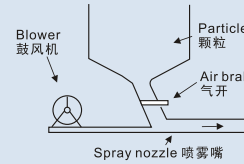

Transferring the particle materials through the air, such as plastic like polyethylene, corn. And it is possible for suction way.

可使用在塑胶行业，空气输送颗粒状原料用。（也可用吸引方式）

Die casting machine 压铸机

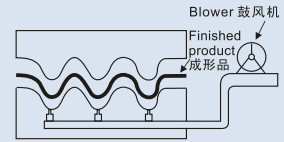

Capable of taking off the processed products from the mold.

可使用于辅助压铸成形零件从模具取下来。

Plating bath 电镀槽

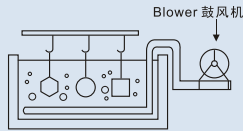

Transfer the air into plating bath to get rid of the bubbles during plating, achieve high quality productions.

为提高电镀产品质量，将空气送入电镀槽内，可去除电解物气泡。

Make manure by fermentation 发酵做堆肥

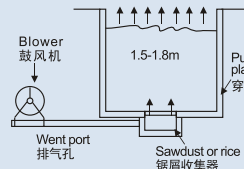

Supply the high-pressure air to the bacterium to make it fermented earlier.

可用于发酵池内的补给氧气，提早发酵。

Instant noodle production line 泡面加工生产线

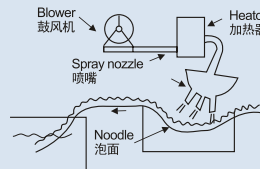

Provide warm and high-pressure wind to eliminate the oil from the noodle.

可使用于以温风去除泡面的油。

Air supply forming pool 养殖池中氧气补给

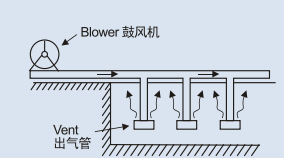

Capable of supplying the oxygen which is taken from the water. Make aquatic product fruitfully.

可使用于水中增氧。

Bottle washer 洗瓶机

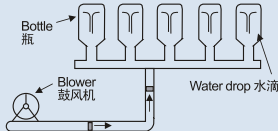

Pressure air to dry the water drops in the bottles after washed.

可使用于洗瓶后，去除瓶内水滴。

Transfer the ricehull 谷类之输送

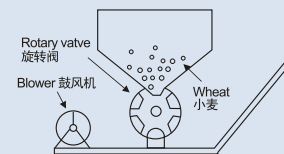

Transferring the dropping wheat with the air when the rotary valve is in operation.

可使用于小麦径旋转阀区分之后落下后进行空气运送。

Dry up the paper of the printer 印刷机的纸干燥

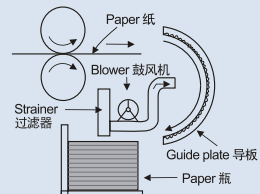

Drying up the paper after printed, so as not to dirty the floor after paper move following the guide plate.

印刷后的油墨干燥时，不会弄脏其他纸的背面。

Clean tanker 净化槽

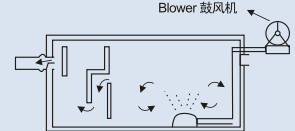

Used to stir the deposit or in water treatment factory to make the shallow water clean.

可使用于搅拌沉淀物，或使用于较浅的水处理工厂。

Auto knitter 自动编织机

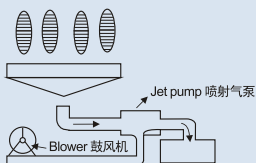

With its tension force, it can knit the materials as well as collect the dust in an easier way.

气流产生拉力使编织物更容易编织，也可用于集尘。

Medical bathtub 医疗浴缸

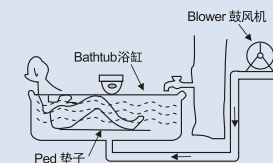

The bubble in the tub is good for human health; it can be used in hospital and hotel.

在浴缸内产生气泡对健康有益，在医院、饭店大多有使用。

Mold cleaner 模具清洁

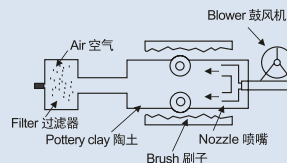

Blowing off the pottery clay when the rotating brush is cleaning the surface of the mold of the tile.

转动刷子清洁磁砖模具面时，产生的陶土可被吹除。

Dry up the electronic plate 干燥用空气刀

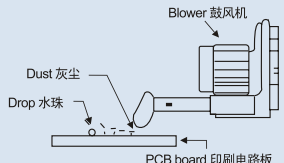

Blowing off the tiny dust and water drop from the circuit board in the electronic industry.

可利用高压气流来吹除印刷电路板上的微小灰尘及水滴。

Application: Air Suction 应用举例：吸风用

Punching machine 打孔机

The waste paper can be collected in the straining box.

打孔后的残纸可以被收集到过滤箱内。

Printing machine 印刷机

After printed, the speed of paper needs to be slowed down before collected. Air suction can keep the paper on the reduction roll easier.

高速印刷后的纸，在堆积前会减速，鼓风机可以让纸吸附在减压滚轮上。

Printing machine 印刷机

Fixing the paper so that the printing can be performed smoothly and the paper won't be in a mess.

吸著固定印刷纸，防止印刷偏移。

Industrial sewing machine 工业用缝纫机

Collecting the leftovers of the threads automatically when the industrial sewing machine is in operation.

工业用缝纫机作业时会产生很多线屑，可用鼓风机自动吸取。

Stapling machine 制书机

To keep the books in order when the stapling machine is cutting the books.

可适用于切断时，保持书本吸著。

Automatic packing machine 自动包装机

Capable of collecting the scrap of the adhesive tape.

可去除膠帶碎屑端。

Hose knitting machine 袜子纺织机

To keep the hose in the correct direction so as to prevent the knotting or uneven knitting.

借助鼓风机的吸著力保持正确方向，防止打结或纺织不均。

Loom 织布机

The blower can strengthen the thread as well as collect the tread tails.

可适用于横线拉紧，回收残线及端末。

Food processed machine 食品加工机

Making the food flavored when the food is soaked in a processed machine in vacuum.

使用于食品调味时真空浸泡用。

Transferring the particles 粉粒体输送

Using in transferring the rice wheat, bean, powder, the residue of the bean curd, almond and so on.

使用于搬运米、麦、大豆、粉、豆腐渣、杏仁等。

Layer die casting machine 薄层压铸机

The blower can take off the excess air from the surface before casting.

鼓风机稳定的吸著力，在压铸成薄层前，要去除表面多余的空气。

Constructive site 工程现场

Blowing off the dust or the poisonous air in the narrow part of the tunnel of constructive site.

用于隧道工程等工地，以排除粉尘及有害气体。

Dustless room 无尘室

Used in the production line where requires extremely clean or move away from the poisonous chemicals.

用于需要非常干净的制造过程，或须隔离有害化学物质，在狭窄空间内换气。

Welding machine 焊接机

Used for eliminating the smoke, heat and gas produced by welding.

可适用于去除焊接作业中产生的烟、热气等气体。

Cloth press 布料压烫机

To suck the steam produced by the press and guide it go through the pad.

布料压烫时，为有效压烫会产生蒸气，吸引蒸气通过垫片，平整布料并清除蒸气。

Drying up the water drop 洗车时之水滴去除

Drying up the water drop when clean the car.

使用于洗车抹布真空脱水。

Caution: Ring Blowers are designed for handling dry, clean air and nonflammable, non-corrosive, non-explosive gases. It shall be used in suitable site with good ventilation and less dust and humidity. Maximum ambient temperature at the inlet is 40 C. Intake filtration should be used to eliminate solids and impurities from entering the blower.

注意：气泵只能使用于干净、干燥的空气，不能用于输送可燃、腐蚀及易爆的气体。必须安装在通风良好明蔽的场合。周围环境温度不应超过40℃。当空气中含有杂质时，应在进气口加装100目的空气过滤。

RB 系列旋涡气泵 铝合金压铸壳体, 特点为流量大
Series Ring Blower Bigger Air Flow

RB2

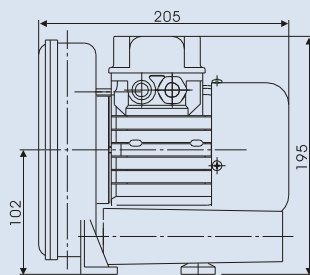
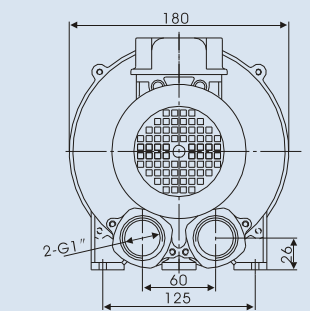
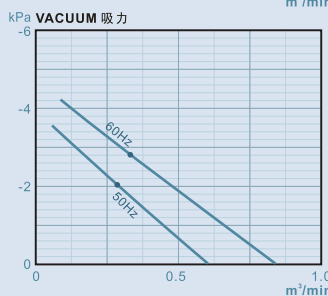
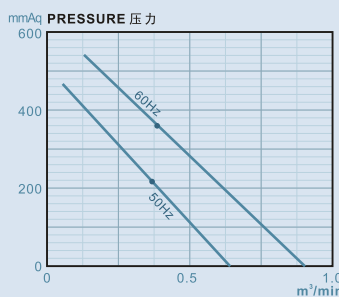

RB10

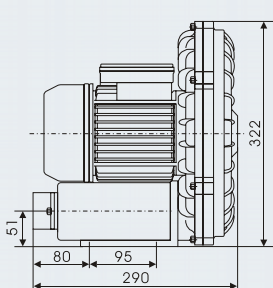
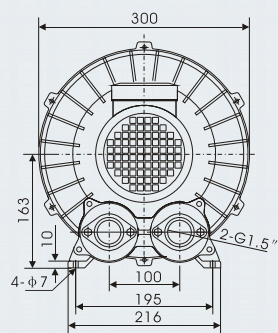
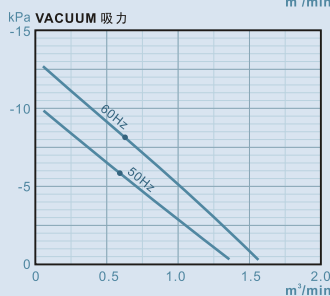
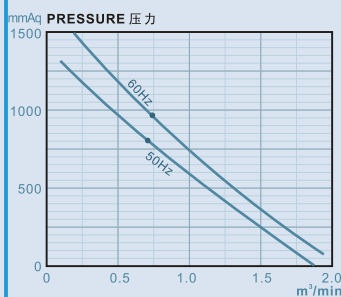

RB15

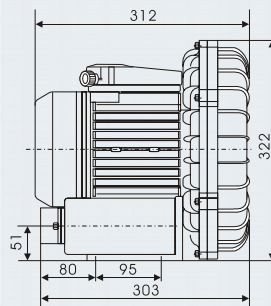
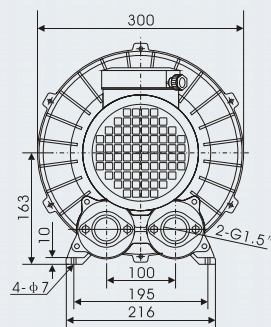
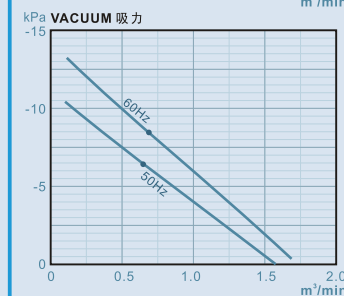
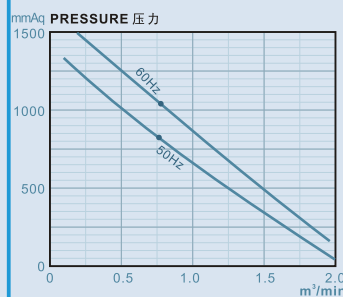

RB20

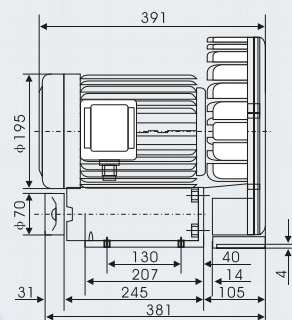
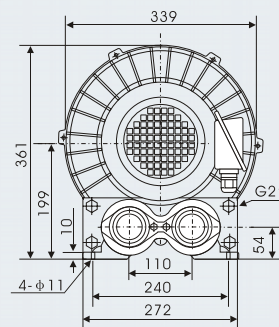
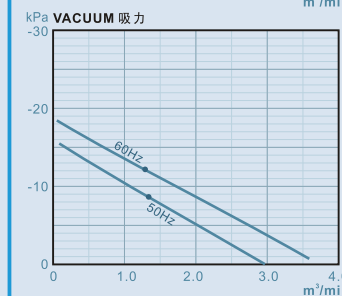
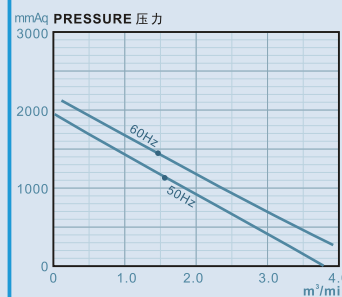

RB

系列旋涡气泵 铝合金压铸壳体, 特点为流量大

Series Ring Blower Bigger Air Flow

RB30

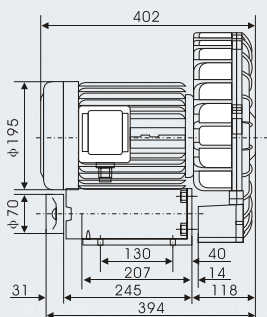
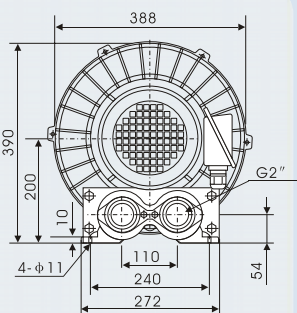
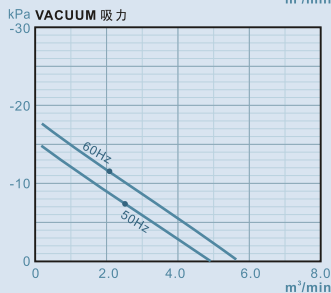
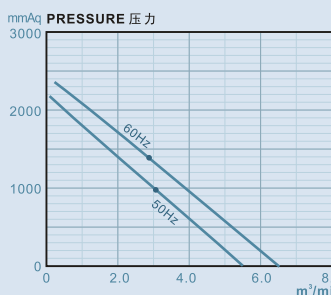

RB50

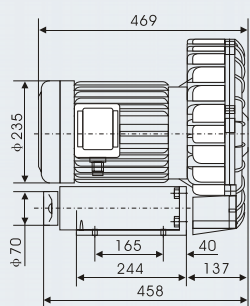
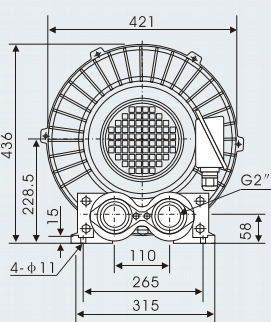
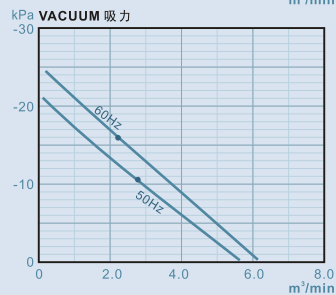
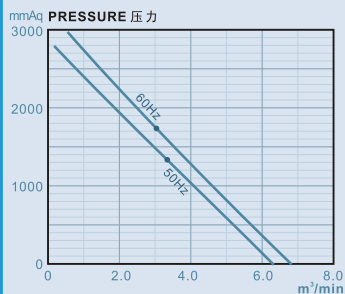

RB50A

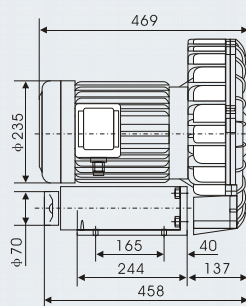
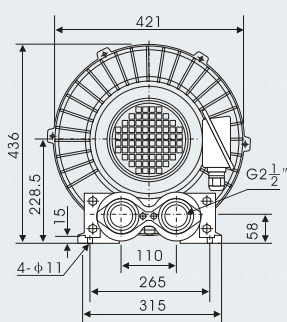
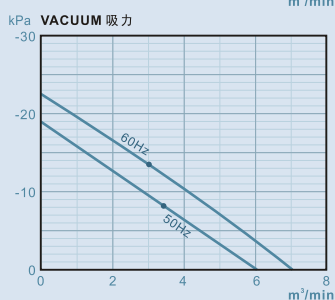
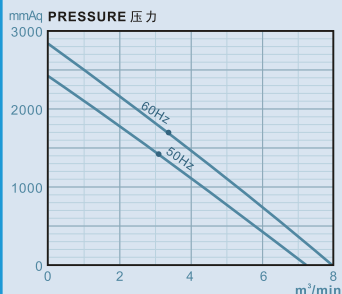

RB75

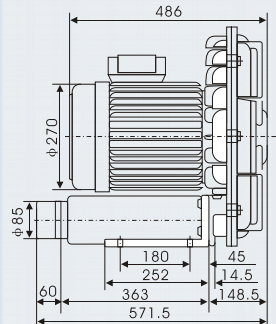
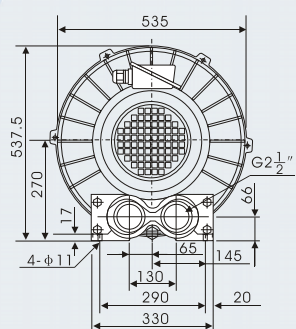
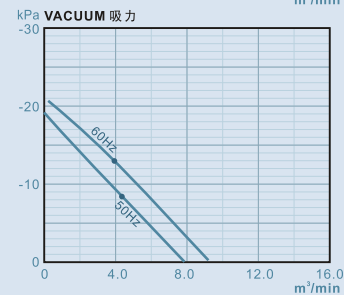
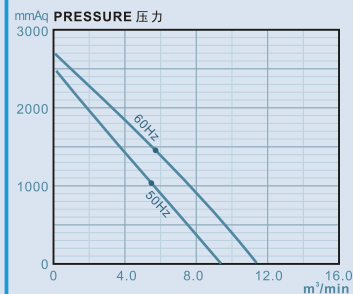

RB 系列旋涡气泵 铝合金压铸壳体, 特点为流量大
Series Ring Blower Bigger Air Flow

RB100

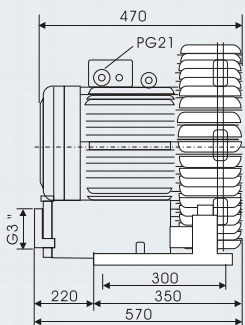
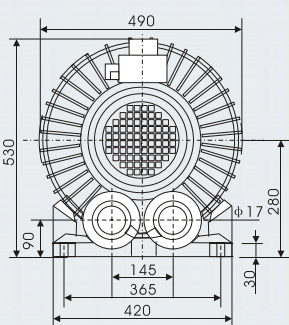
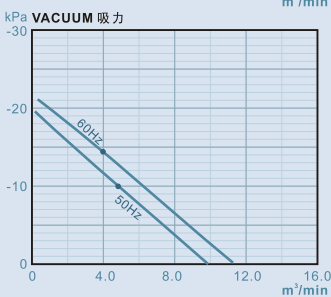
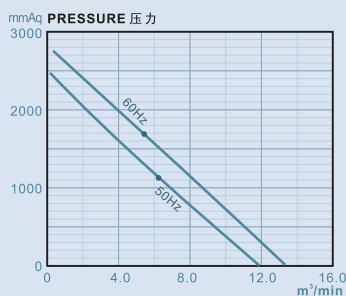

RB150

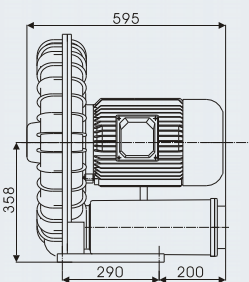
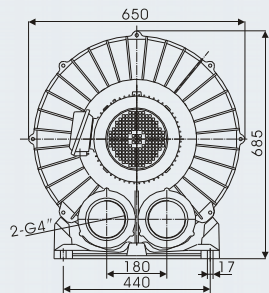
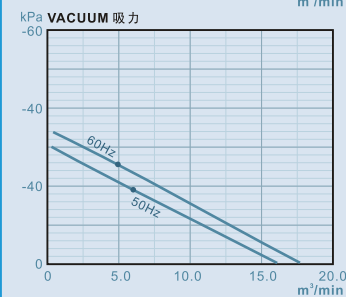
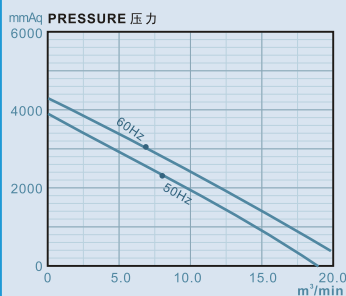

RB200

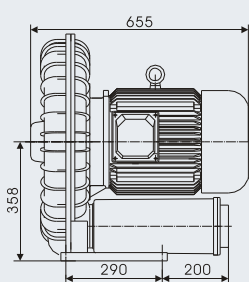
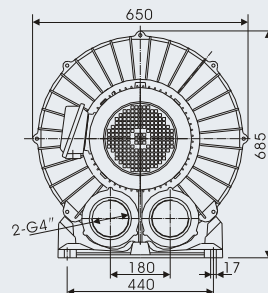
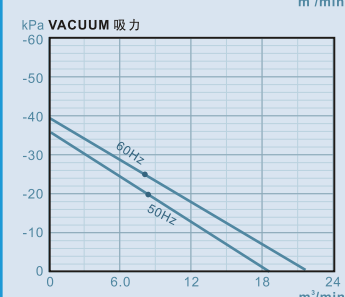
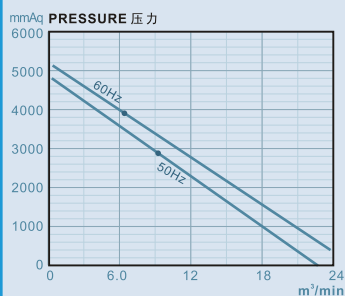

HB

HB370

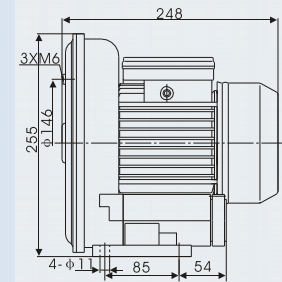
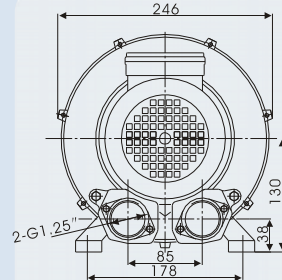
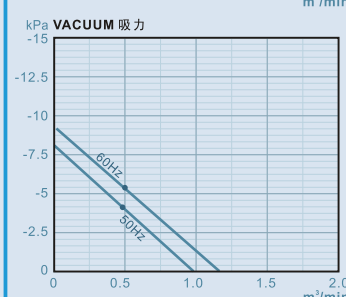
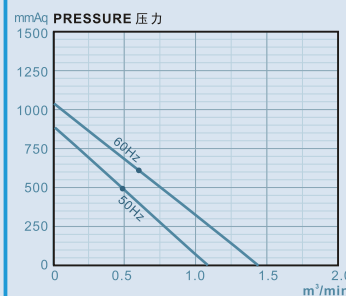

系列旋涡气泵 铝合金压铸壳体, 特点为压力高

HB Series Ring Blower High Pressure With Pressure Casting Components

HB550

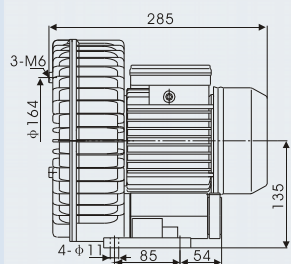
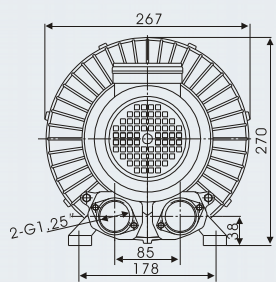
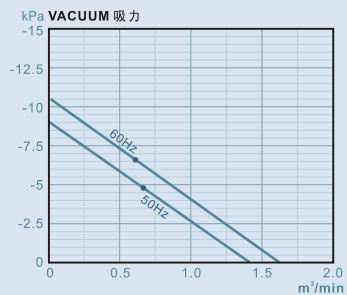
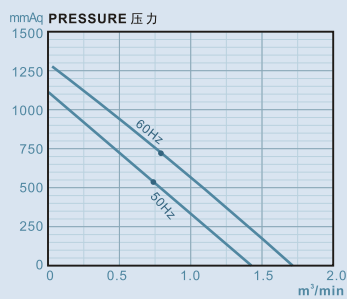

HB750

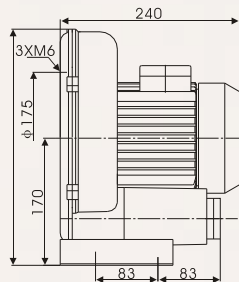
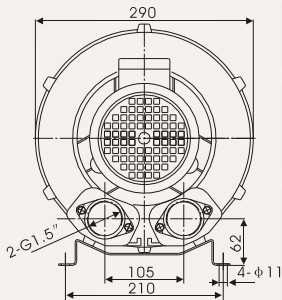
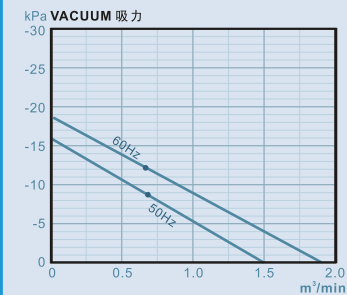
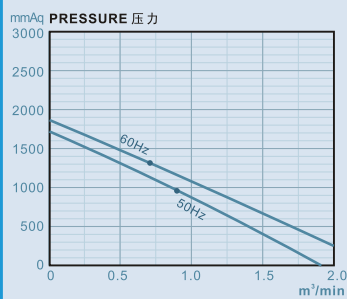

HB1100

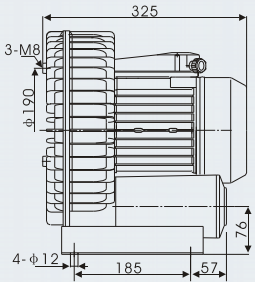
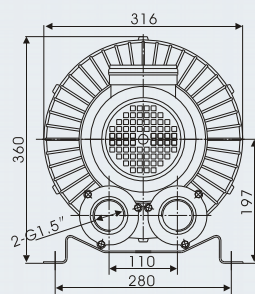
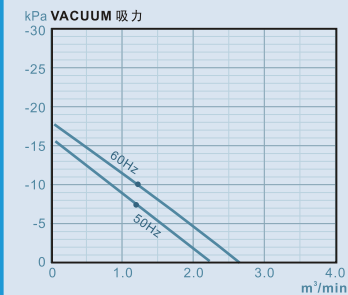
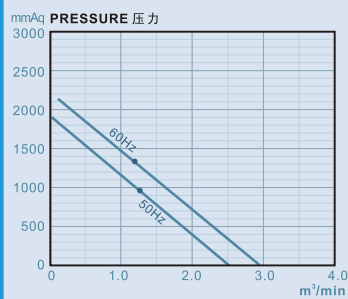

HB1500

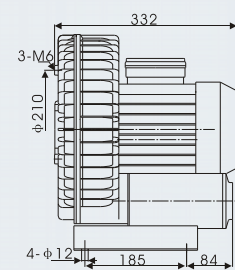
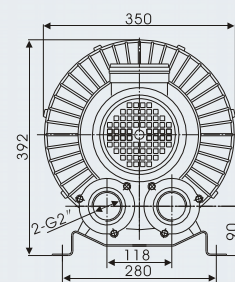
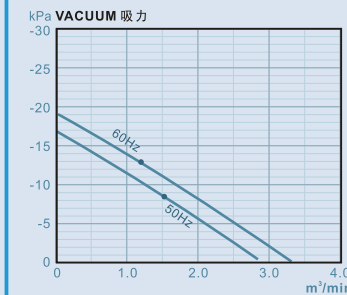
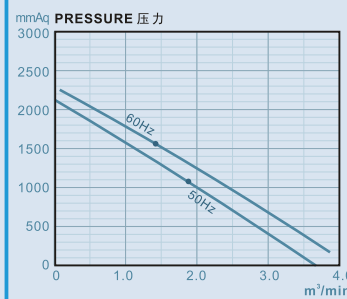

HB Series Ring Blower High Pressure With Pressure Casting Components

系列旋涡气泵 铝合金压铸壳体, 特点为压力高

HB2200

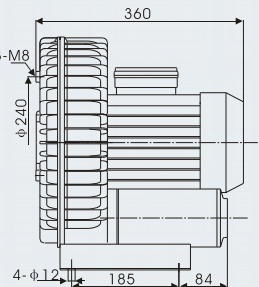
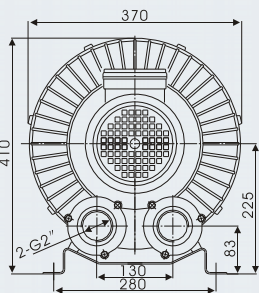
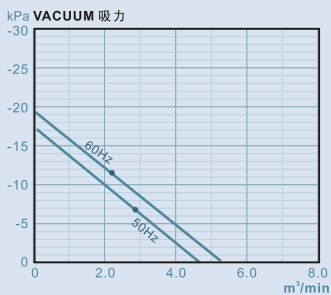
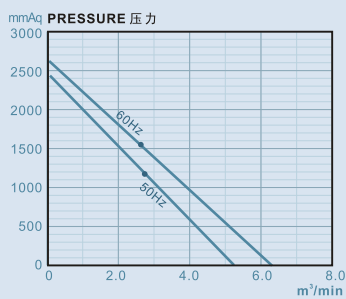

HB3700

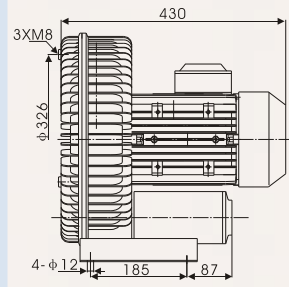
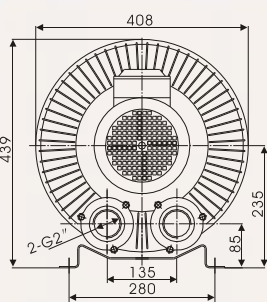
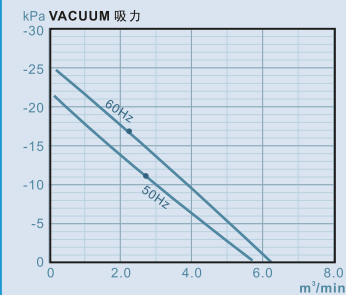
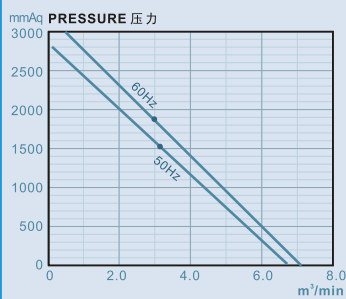

HB5500

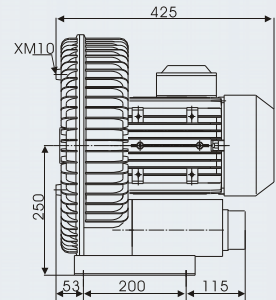
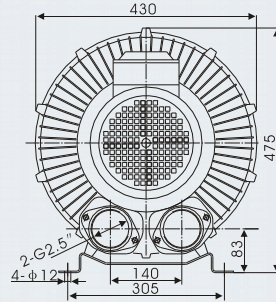
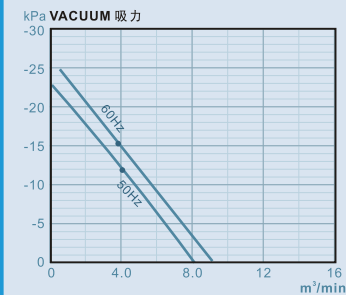
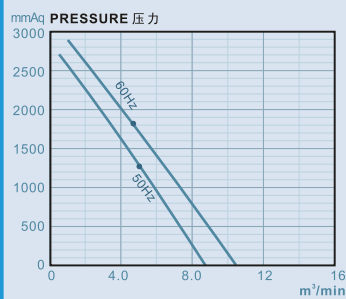

HB7500

