

JETS Series self-priming JET Pumps

JETS 系列自吸喷射流泵



PERFORMANCE CHART AT n=2900r/min

折算到 2900r/min 时性能

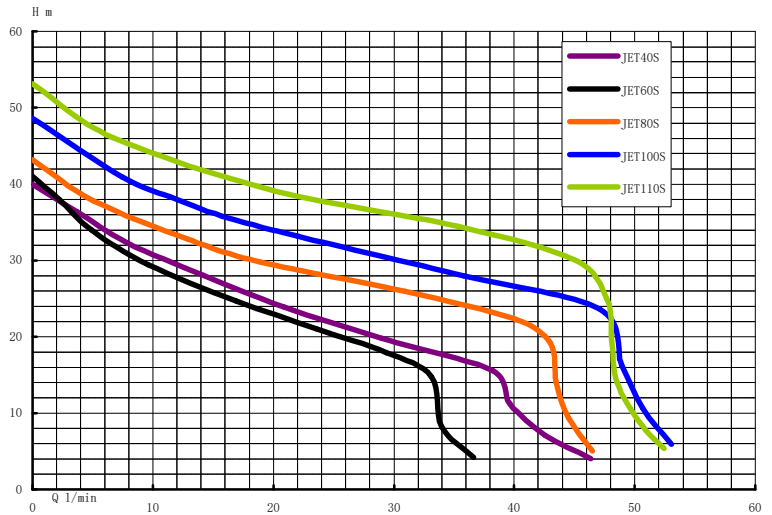

Working Conditions

Max Temperature of Fluid up to +50°C

Max Pressure 8bar,

Max Ambient Temperature up to 40°C

Should be installed in a covered area, protected against the weather.

工作条件：

最高流体温度为 50°C

最大可承受的压力 8bar

最高环境温度 40°C

电泵应安装在掩蔽的场所。

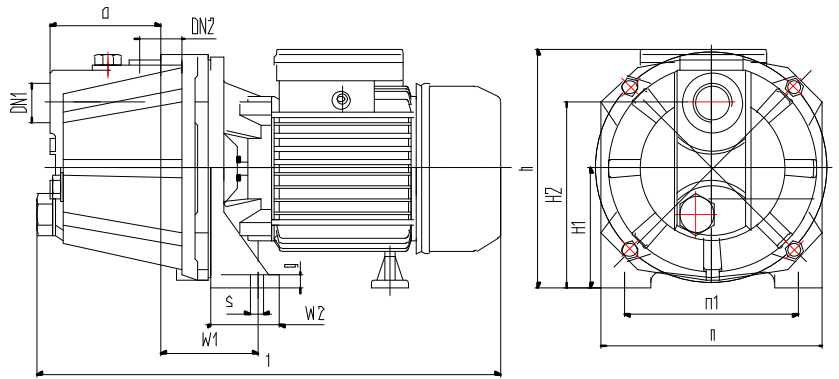

JETL Series self-priming JET Pumps

JETL 系列自吸喷射流泵



PERFORMANCE CHART AT n=2900r/min

折算到 2900r/min 时性能

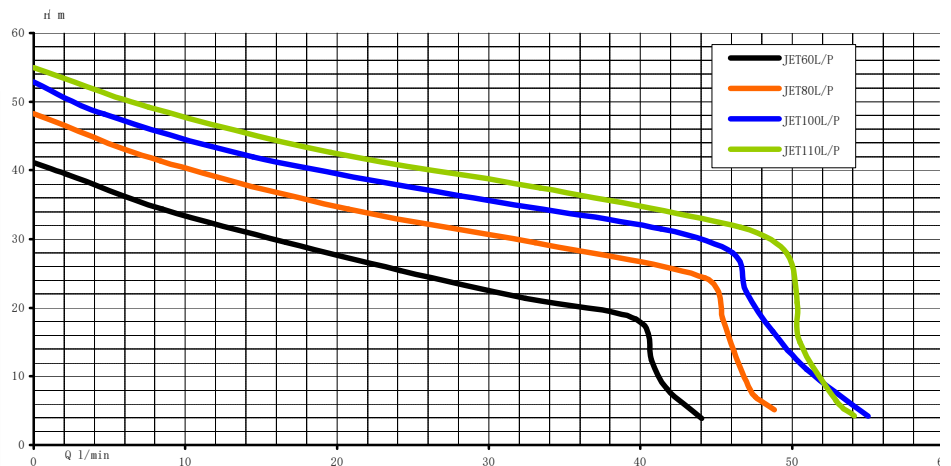

Working Conditions

Max Temperature of Fluid up to +50°C

Max Pressure 8bar,

Max Ambient Temperature up to 40°C

Should be installed in a covered area, protected against the weather.

工作条件：

最高流体温度为 80°C

最大可承受的压力 10bar

最高环境温度 40°C

电泵应安装在掩蔽的场所。

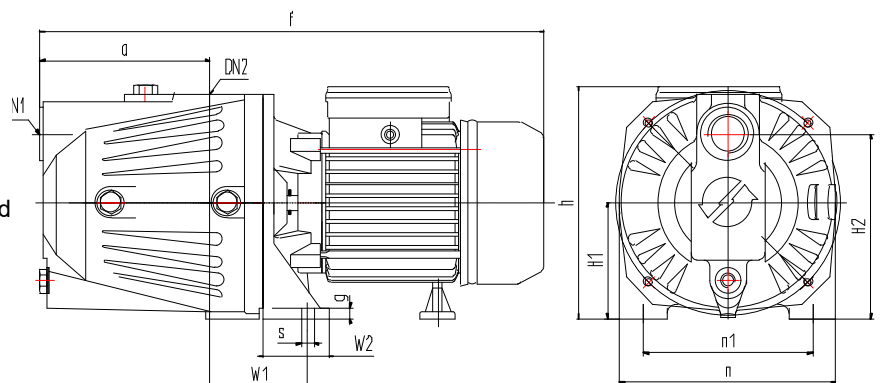

Technical Data (at 220V/50Hz single phase) 技术参数 (220V/50HZ 单相)

Type 型号	OutPutPower 输出功率		Current 电流 A	Capacitor 电容器 µF	H max 最高扬程 m	Q max 最大流量 l/min	Size 进出口径	S.Head 最大吸程 M	Total head - 总扬程 m	Capacity - 流量 l/min							
	kW	HP								5	10	20	30	40	50		
JET40S	0.37	0.5	2.1	12	40	46	1"X1"	9		5	10	20	30	40	50		
JET60S	0.4	0.53	2.4	12	40	37	1"X1"	8		35	31	24	19.5	10			
JET80S	0.55	0.75	3.7	16	43	46	1"X1"	8		35	29	23	18				
JET100S	0.75	1	4.6	20	48	53	1"X1"	8		38	34	29	26	22			
JET110S	0.9	1.2	4.9	20	53	52	1"X1"	8		44	39	34	30	26.7	9		
										47	44	39	36	33	12		

Type 型号	Dimensions - 外形尺寸 mm											Weight 重量 kg		PackingSize 包装尺寸 mm			PackingQTY.包装数量	
	a	f	h	H1	H2	W1	W2	n	n1	g	s	NW	GW	L	W	H	Eu.pallet 欧式托盘	20'Cont. 20'柜
JET40S	94	366	178	90	130	89	60	142	96	7	8	8.7	9.5	385	175	215		1500
JET60S	90	380	196	98	152	79	55	182	142	9	11	11.8	12.6	420	215	220		1300
JET80S	90	380	196	98	152	79	55	182	142	9	11	12.5	13.5	420	215	220		1300
JET100S	90	380	196	98	152	79	55	182	142	9	11	13.1	14.1	420	215	220		1300
JET110S	90	380	196	98	152	79	55	182	142	9	11	13.8	14.8	420	215	220		1300

- I The self-priming electric pumps of the JET series, based on the **Venturi** principle, give higher head than centrifugal pump and larger capacity than peripheral pump and also without power limited in its working rang. They are suitable to convey clean water and non-aggressive chemical fluids, even with liquid mixed with gas, from well in continuous duty; they are also indicated to increase water pressure in centralized water systems, for small irrigation systems, for watering gardens, for washing systems with water jets, for fountains, etc. It is normally advisable to install a foot valve on the suction branch.
- I Standard data and equipment: single phase 220V/50Hz, NORYL impeller, carbon steel motor shaft, with motor protector inside.
- I Others model and material such as three phase, 110V, 60Hz, dual voltage, stainless steel shaft, etc, will be available upon request.
- I Warranty: 12 months

- U 自吸泵 JET 系列由于采用了 VENTURI 原理, 可以为用户提供比离心泵高的扬程及比旋涡泵大的流量, 而且在其运行范围内不受功率的限制。用于输送清水及不具腐蚀性的化学流体, 特别是气液混合的流体。可用于井中连续取水、楼房的自动给水、小规模灌溉、园艺用水及喷泉等。建议在其进水管的底部装上底阀以提高自吸性能。
- U 标准的参数及配置: 单相 220V/50Hz、NORYL 叶轮、碳钢轴、马达内置热保护器。
- U 可根据客户的其它参数及材料的要求, 制作如三相电泵、110V、60Hz、双电压、不锈钢轴等规格的产品。
- U 保修期: 12 个月。

Technical Data 技术参数

Type 型号	OutPutPower 输出功率		Current 电流 A	Capacitor 电容器 µF	H max 最高扬程 m	Q max 最大流量 l/min	Size 进出口径	S.Head 最大吸程 M	Total head - 总扬程 m	Capacity - 流量 l/min							
	kW	HP								5	10	20	30	40	50		
JET 60L P	0.4	0.53	2.4	12	40	42	1"X1"	8		5	10	20	30	40	50		
JET 80L P	0.55	0.75	3.7	16	48	48	1"X1"	8		37	33.5	28	22	18			
JET100L P	0.75	1	4.6	20	52	54	1"X1"	8		44	40	34.5	30.5	26.8			
JET110L P	0.9	1.2	4.9	20	54	54	1"X1"	8		48	44.5	39.5	36	32	13		
										51	48	42.5	38.8	35	24		

Type 型号	Dimensions - 外形尺寸 mm											Weight 重量 kg		PackingSize 包装尺寸 mm			PackingQTY.包装数量	
	a	f	h	H1	H2	W1	W2	n	n1	g	s	NW	GW	L	W	H	E.pallet 欧式托盘	20'Cont 20'柜
JET 60L P	143	425	196	98	156	79	55	182	142	9	11	14.3	15.3	480	210	220		1340
JET 80L P	143	425	196	98	156	79	55	182	142	9	11	14.7	15.7	480	210	220		1340
JET100L P	143	425	196	98	156	79	55	182	142	9	11	15.9	16.9	480	210	220		1340
JET110L P	143	425	196	98	156	79	55	182	142	9	11	16.4	17.4	480	210	220		1340

- I These three series self-priming JET pumps equipped with some Venturi system each. They are suitable to convey clean water and non-aggressive chemical fluids, even with liquid mixed with gas, from well in continuous duty; they are also indicated to increase water pressure in centralized water systems, for small irrigation systems, for watering gardens, for washing systems with water jets, for fountains, etc. It is normally advisable to install a foot valve on the suction branch.
- I Standard data and equipment: single phase 220V/50Hz, NORYL impeller, carbon steel motor shaft, with motor protector inside.
- I Others model and material such as three phase, 110V, 60Hz, dual voltage, stainless steel shaft, etc, will be available upon request.
- I Warranty: 12 months
- U 该三种自吸泵 JET 系列各自装备了相同的 VENTURI 装置, 可用于输送清水及不具腐蚀性的化学流体, 特别是气液混合的流体。可用于井中连续取水、楼房的自动给水、小规模灌溉、园艺用水及喷泉等。建议在其进水管的底部装上底阀以提高自吸性能。
- U 标准的参数及配置: 单相 220V/50Hz、NORYL 叶轮、碳钢轴、马达内置热保护器。
- U 可根据客户的其它参数及材料的要求, 制作如三相电泵、110V、60Hz、双电压、不锈钢轴等规格的产品。
- U 保修期: 12 个月。